

# ZERO

POWERED BY  
**AQUAPORIN** INSIDE®

## **FILTER REPLACEMENT GUIDE**

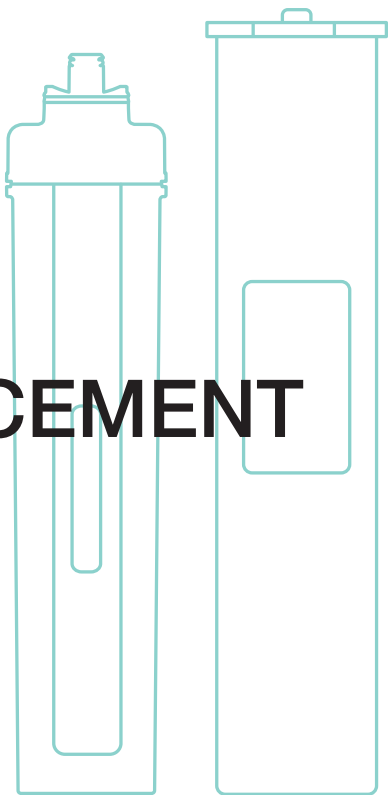

The following instructions apply to the replacement of the pre- and post-filters as well as the RO filters in ZERO.

- Replace the cartridge no later than 12 months from the date of installation.
- Replace the battery (DL2032) of the LED indicator each time you replace the cartridge.
- If the system is left idle for more than 60 days, it is recommended to replace the filters.



See installation video, Q&A and more on [www.aquaporin.com/installation](http://www.aquaporin.com/installation) or scan the QR code

1

Turn the faucet on.

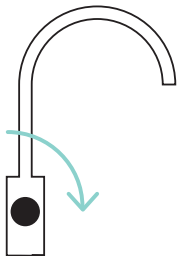

2

Dispense 3 liters of water to empty the tank.

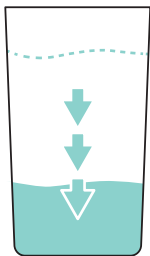

3

Turn off the cold water valve.

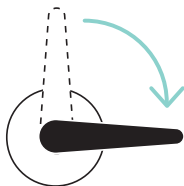

4

Open the lid.

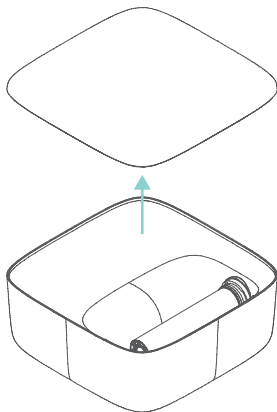

5

Remove pre- and post-filter by unscrewing them counter-clockwise and pull down.

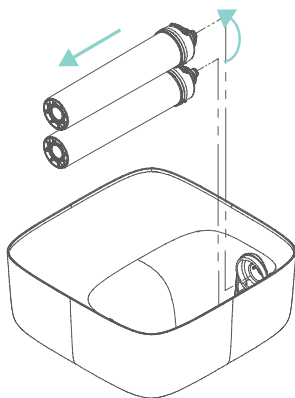

6

Remove the inside cover by pinching gently on the inside and outside of the cover and remove it as shown on the illustration.

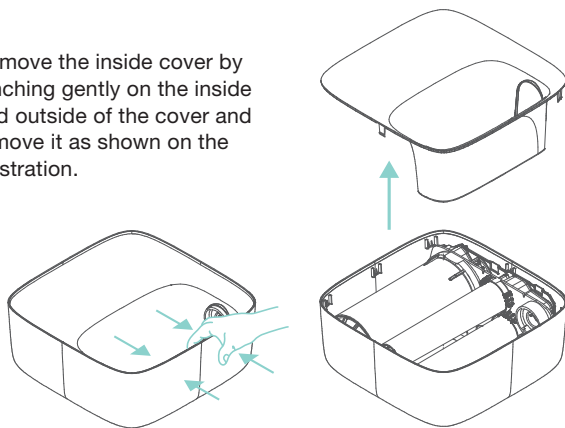

7

Remove the two RO filters by unscrewing them counter-clockwise and pull down.

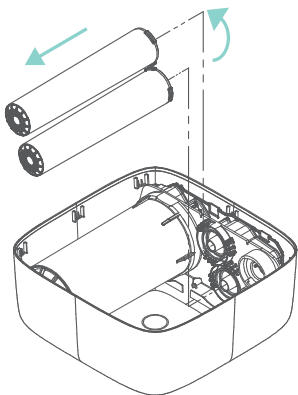

8

Before you insert the new RO filters, wet the O-ring. Insert the new RO filters by pushing them in and tighten by screwing clockwise.

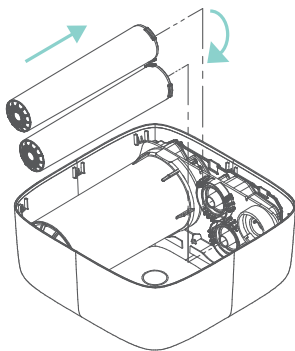

9

Put the internal cover back on.

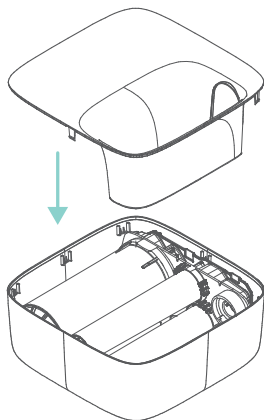

10

Before you insert the new pre- and post-filters, wet the O-ring. First, insert the post-filter followed by the pre-filter by pushing them in and tighten by screwing clockwise.

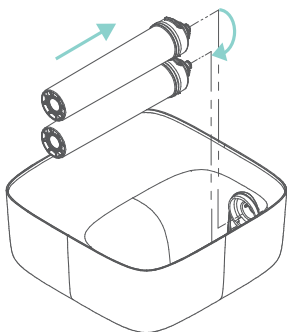

**11**

Put the lid back on.

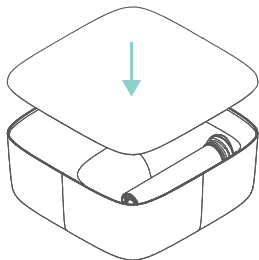

**12**

Turn on the cold water valve.

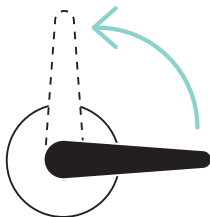

**13**

After replacing the filters the system must be flushed before consuming the water. This is done by leaving the faucet open for 15 minutes. The water flow will be slow since the tank is empty. When you close your faucet after 15 minutes the tank will start to fill.

If you experience noises from your ZERO it can be caused by air in the machine. Please follow the steps in the USE section in the installation guide.

Aquaporin A/S  
Nymøllevej 78  
2800 Kongens Lyngby  
Denmark

Tel: +45 82 30 30 82  
sales@aquaporin.com

[aquaporin.com/zero](https://aquaporin.com/zero)