

ZERO

POWERED BY
AQUAPORIN INSIDE®

USE AND INSTALLATION GUIDE



See installation video, Q&A and
more on www.aquaporin.com/installation
or scan the QR code

INSTALLATION	6
DRAIN INSTALLATION	7
INLET INSTALLATION	9
FAUCET INSTALLATION	12
OUTLET INSTALLATION	14
TAP FUNCTIONS	16
FLOW RESTRICTOR KIT	17
USE	18
REPLACEMENT OF CARTRIDGES	19
SYSTEM SPECIFICATIONS	23

WARNING:

This equipment requires regular maintenance to ensure the treated water's potability; use it in accordance with the instructions in this user guide.

For installation manuals in other languages, please contact the place where you bought your ZERO or visit www.aquaporin.com/installation.



design odo fioravanti

PATENTED
MADE IN ITALY



HONORABLE MENTION 2015
ADI
COMPASSO D'ORO
INTERNATIONAL
AWARD

Produced by
C.C.I.A.A. PD352571
for Aquaporin

WEIGHT AND DIMENSIONS

Gross weight: 7.2 kg
Net weight: 5.7 kg

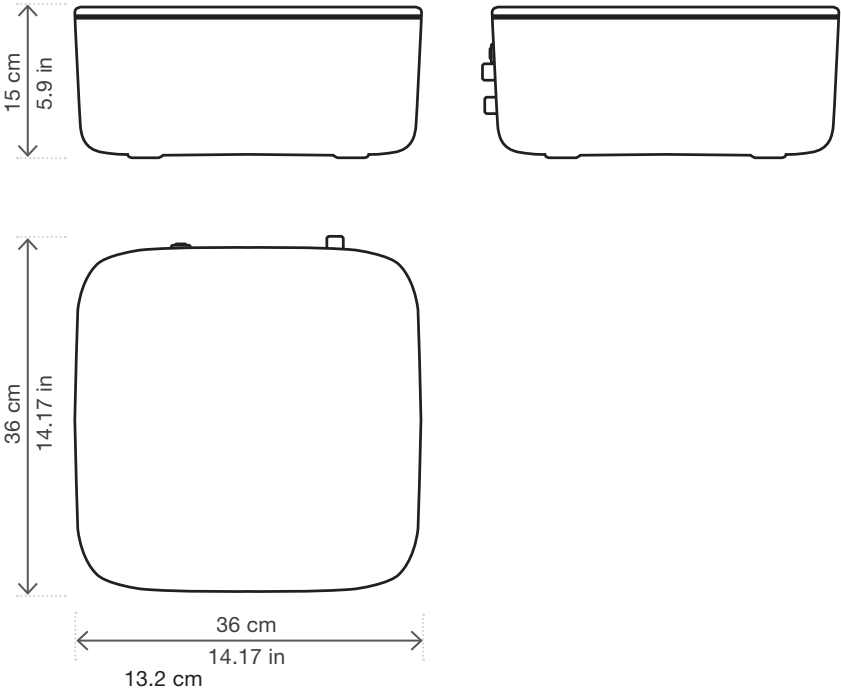

COMPONENT LIST



A
T-fitting
F/F/M

1 piece



B
Mini ball
valve M/F

1 piece



C
Straight M
adapter
8 mm x 3/8"

1 piece



D
Drain
clamp
kit

1 piece



E
Stem
elbow
8 mm

2 pieces



F
Straight
female
connector

2 pieces



G
PE pipe
8x6 mm OD

3 m
6.56 ft



H
PE pipe
1/4" OD

1 m
3.28 ft



I
Stem
elbow 1/4"

1 piece



J
Straight
female
adapter

1 piece



K
O-ring
3021

1 piece



L
Gooseneck
faucet kit

1 piece



M
Teflon tape /
Plumber's
tape

1 piece

Tools required for installation



Electrical
drilling
machines
(6 mm and
12 mm drill)



Philips
screwdriver

INSTALLATION SCHEME

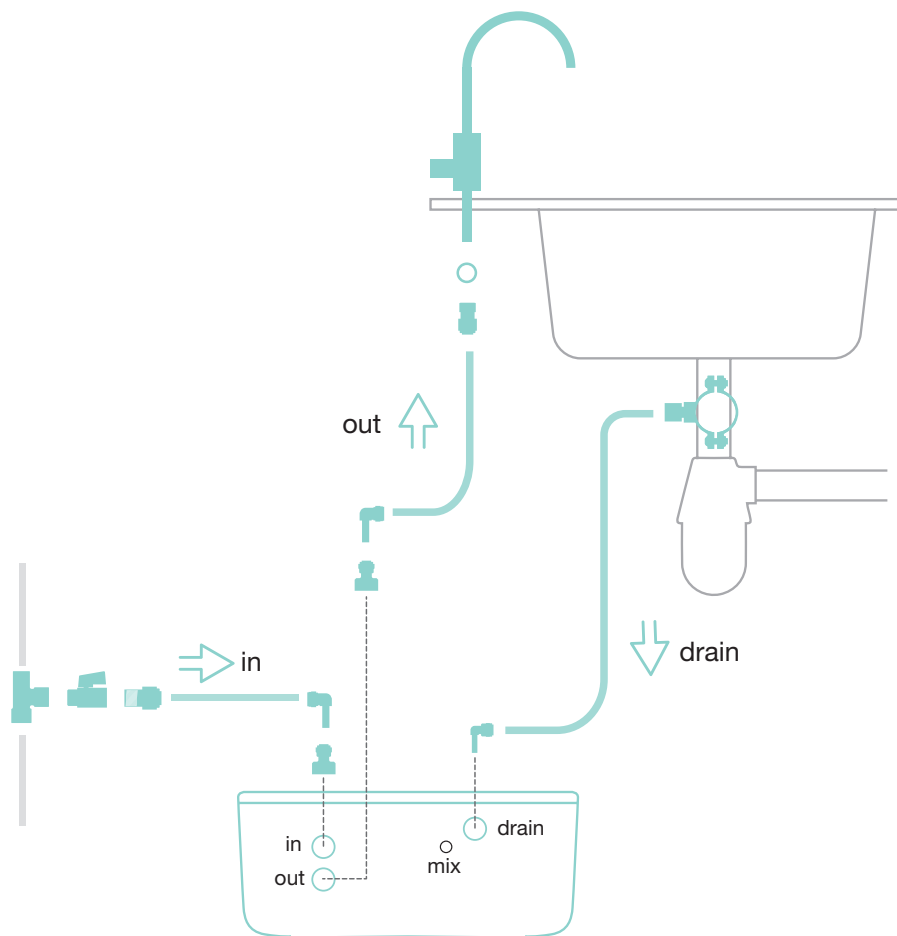

INSTALLATION

Before you start, please be sure to clean your hands thoroughly as well as any tools used during the installation of your ZERO.



Before installation, ensure that the cold water valve is turned off/closed

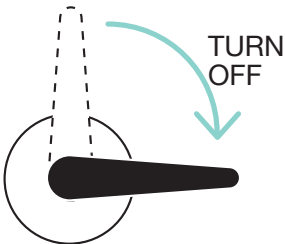

Before installation, remove the yellow IN and OUT plugs as well as the DRAIN plug. Keep the plugs as they will be reused if the device is relocated.

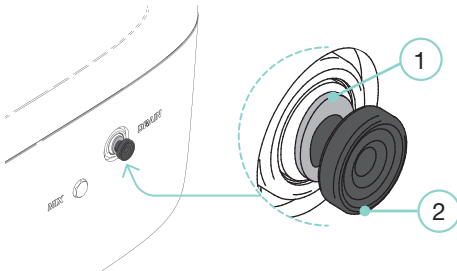
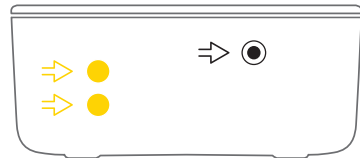

Drain plug extraction

1. Keep the collet pressed down
2. Pull out the plug

DRAIN INSTALLATION

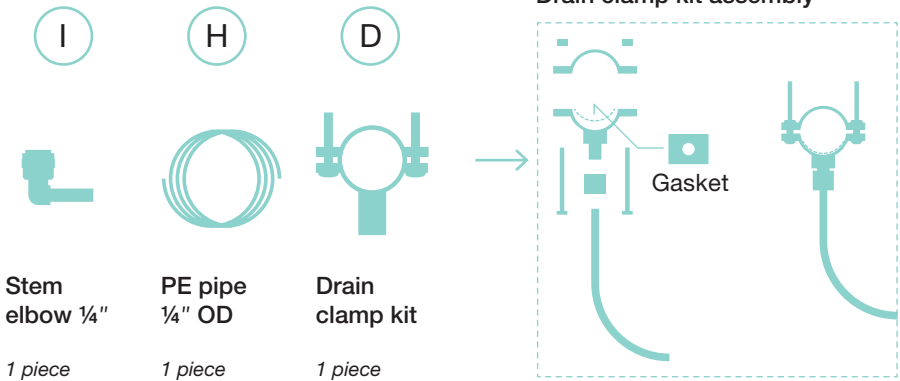

1/3

Tighten the clamp with the Phillips screwdriver.

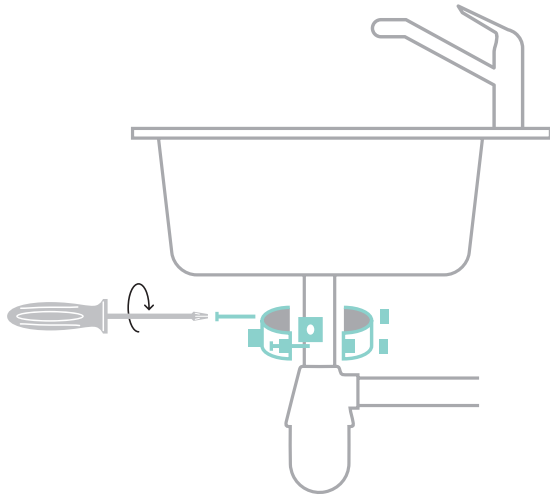

2/3

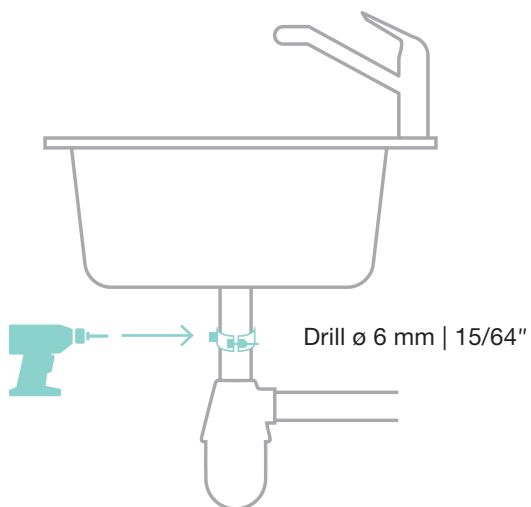

3/3

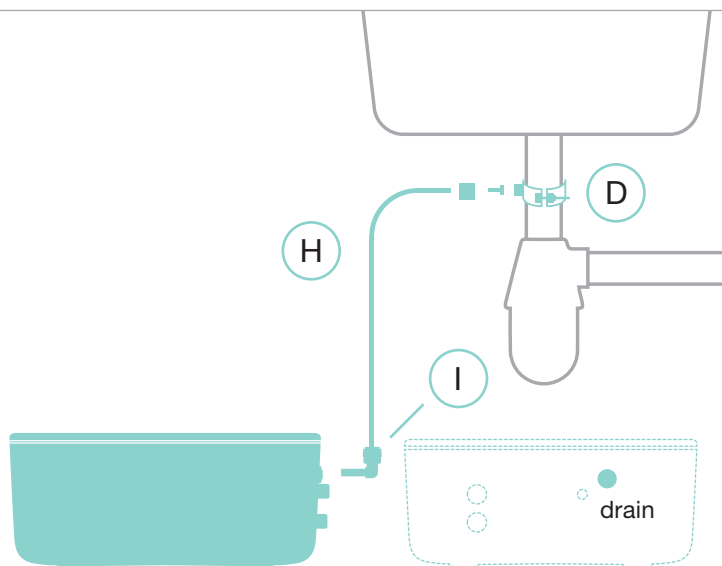

INLET INSTALLATION

A



**T-fitting
F/F/M**

1 piece

B



**Mini ball
valve M/F**

1 piece

C



**Straight M
adapter
8 mm × 3/8"**

1 piece

F



**Straight
female
connector**

1 piece

G



**PE pipe
8x6 mm OD**

Cut length to fit

E



**Stem elbow
8 mm**

1 piece

M



**Teflon tape /
Plumber's
tape**

1 piece

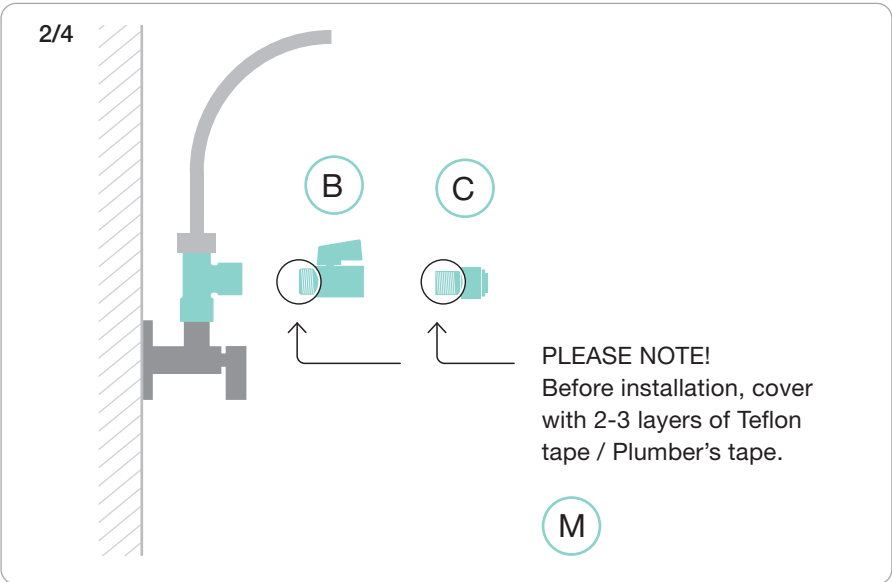
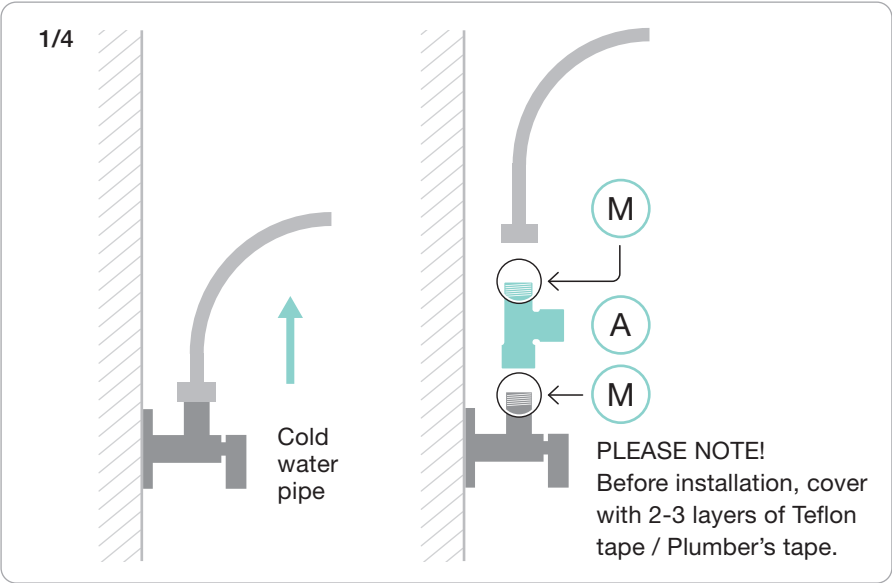

3/4

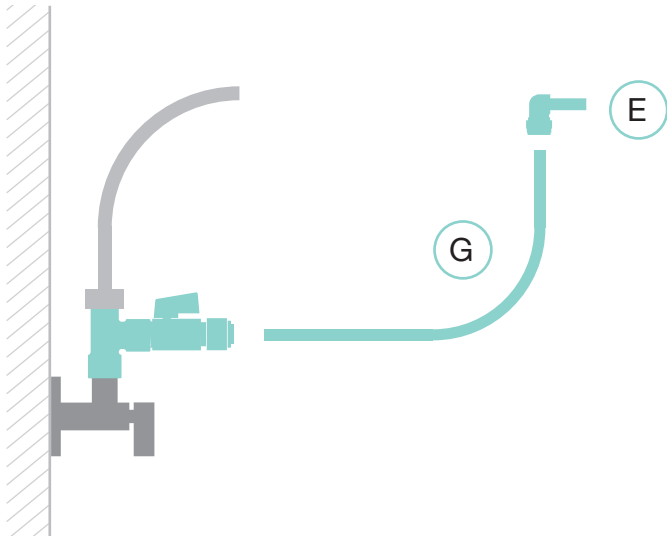



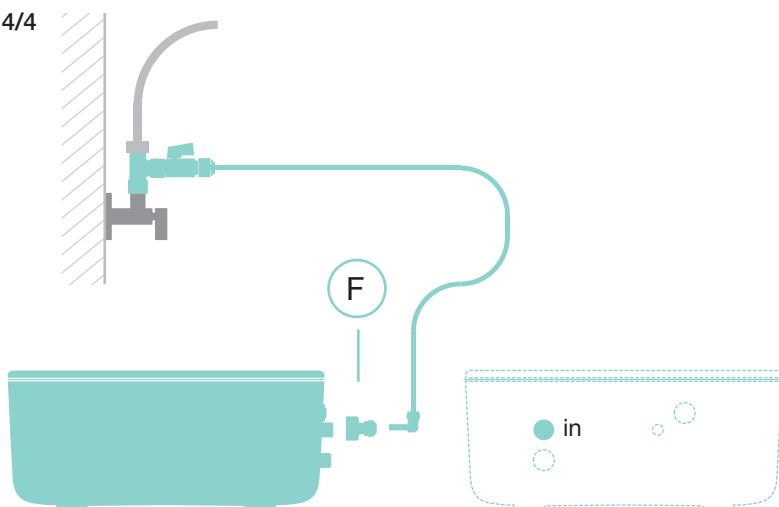









4/4



FAUCET INSTALLATION

For the faucet operation instructions, see page 16.

					
					
Faucet	Spacer with o-ring	Rubber gasket	Plastic washer	Toothed washer	Fixing nut
<i>1 piece</i>	<i>1+1 pieces</i>	<i>1 piece</i>	<i>1 piece</i>	<i>1 piece</i>	<i>1 piece</i>

1/2

Drill \varnothing 12 mm | 15/32"

Drill a hole adjacent to your regular faucet.

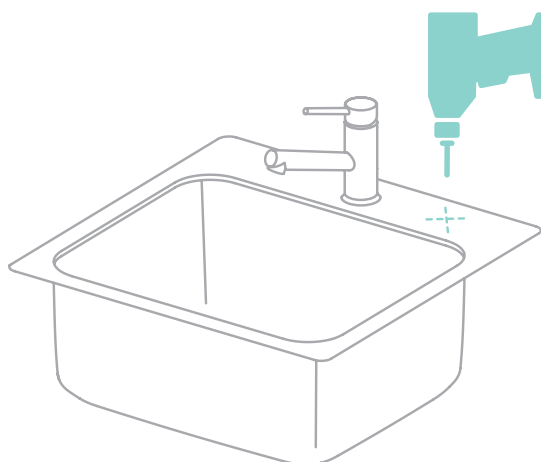
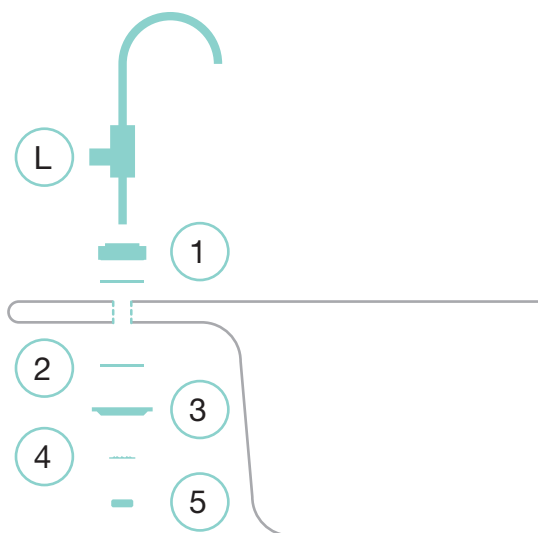
**1/2**

OUTLET INSTALLATION

K



O-ring
3021

1 piece

J



Straight
female
adapter

1 piece

G



PE pipe
8x6 mm
OD

*Use the rest
or cut to fit*

E



Stem
elbow
8 mm

1 piece

F



Straight
female
connector

1 piece

1/2

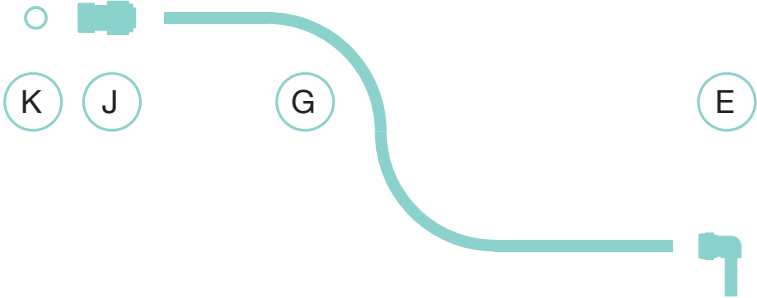

2/2

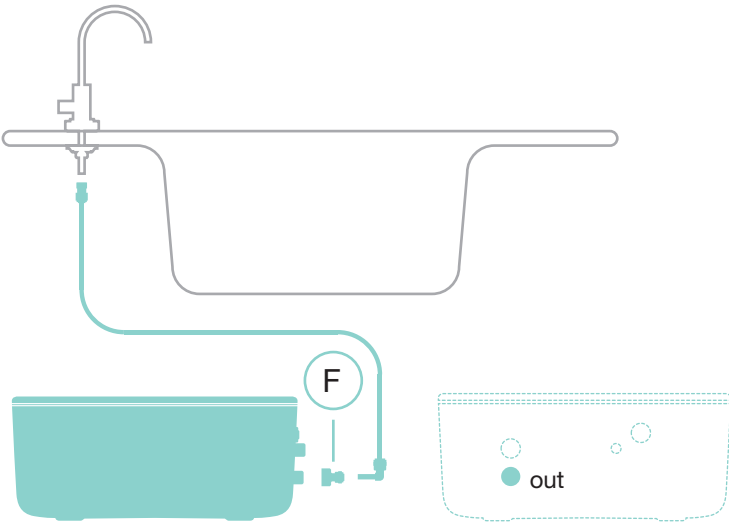

TAP FUNCTIONS

START/RESET THE CIRCUIT

1. Close the faucet tap, insert the battery into the circuit which will be indicated by BLUE LED flashing, then insert the circuit into the faucet tap within 30 seconds. Now wait about 2 minutes until the BLUE and RED LEDs both flash simultaneously for about 10 seconds. This indicates that the circuit has successfully started.

LED light sequence for successful start/reset.

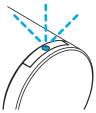

BLUE LED flashes when the battery is inserted.



No flashing for about 2 minutes.

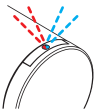

RED and BLUE LED's will flash simultaneously for 10 seconds to confirm the reset procedure.

ATTENTION: DO NOT MOVE THE FAUCET TAP KNOB BEFORE THE SEQUENCE IS COMPLETED

2. If the reset / restart is successful, the BLUE LED flashes while your water flows from the faucet. If the reset / restart is unsuccessful, the RED LED flashes.
3. If the RED LED counting circuit flashes, it indicates that the pre- and post-filters' lifetime have almost been reached. Water can still be used but you must initiate the process of changing the filters soon.
4. When the RED LED remains on, it is time to replace the filters – the RED LED will be lit until the battery is exhausted. See the section replacement of cartridges for guidance. After replacing the filters, insert a new battery to reset the count.
5. If you replace the battery before the RED LED remains on, the count will not be reset. The reset will only happen when replacing the battery while the RED LED is on. In case of early filter replacement, a technician is required to reset the count.
6. If the faucet tap is in normal operation a BLUE LED will flash during dispensing.
7. See the filter exchange guide on www.aquaporin.com/installation for more information.

FLOW RESTRICTOR KIT

In some cases, installing a flow restrictor to your ZERO will enhance the overall performance. The flow restrictor controls the pressure on the RO membrane inside your ZERO and can enhance the water recovery ratio.

It is recommended to apply the flow restrictor if water hardness is below 15° dH.

If you are unsure about the hardness of your water, we recommend to contact your local water supplier.

If a flow restrictor is applicable, then cut the drain pipe, and insert the flow restrictor between the two ends, as shown in the picture. Make sure the fittings are tight.

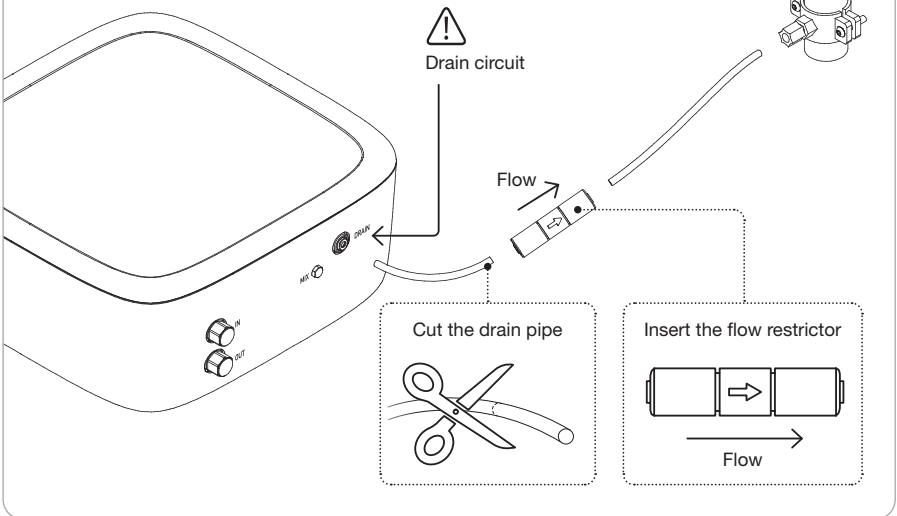

USE

After installation of your ZERO or after replacing the cartridges the system must be flushed before consuming the water. This is done by leaving the faucet open for 15 minutes. The water flow will be slow since the tank is empty. When you close your faucet after 15 minutes the tank will start to fill.

If you leave the system idle for more than three days, it is recommended to flush the system before drinking the

water. Open your faucet and empty the tank by letting 3 liters pass. The tank will now refill automatically and you can drink the water. If you are away for a longer period, you may consider closing the valve for the inlet water.

If the system is left idle for more than 60 days, it is recommended to replace the cartridges.



IF YOU HEAR A NOISE DURING FIRST USE, PLEASE FOLLOW THIS PROCEDURE:

- Put ZERO in the vertical position in order to let the air flow out of the system
- Complete at least 3 cycles of filling and emptying the tank to condition the system
- Put ZERO in a horizontal position

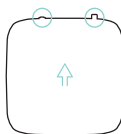

N.B.

The noise should disappear after some cycles and/or after some hours. Depending on pressure there can be a sound of the tank being filled.

REPLACEMENT OF CARTRIDGES

There are 4 filters inside ZERO; an activated carbon pre-filter, which the water initially runs through before entering the two Aquaporin Inside® DWRO™ (drinking water reverse osmosis) filters. Lastly, the water runs through an activated carbon post-filter, all ensuring you clean water.

The pre- and post-filters inside ZERO are silver-coated carbon blocks with antimicrobial properties. The pre-filter removes impurities such as chlorine, organic compounds, and heavy metals. Also, it protects the Aquaporin Inside® DWRO™ membrane. The post-filter is considered a precautionary step to remove bacterial contamination as well as any bad taste or odor which would accumulate in the tank.

The Aquaporin Inside® DWRO™ membrane inside ONE filters out up to >99% of all dissolved solids and contaminants in your tap water.

The cartridge replacement intervals are indicative only as the condition is affected by the quality of the source water which may vary.

- Replace the cartridge no later than 12 months from the date of installation.
- Replace the battery (DL2032) of the LED indicator each time you replace the cartridge.
- If the system is left idle for more than 60 days, it is recommended to replace the cartridges.

1

Turn the faucet on.

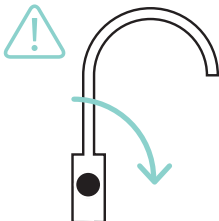

2

Dispense 3 liters of water to empty the tank.

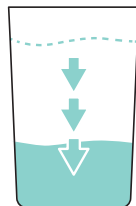

3

Turn off the cold water valve.

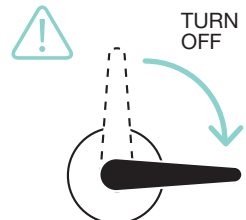

4

Open the lid.

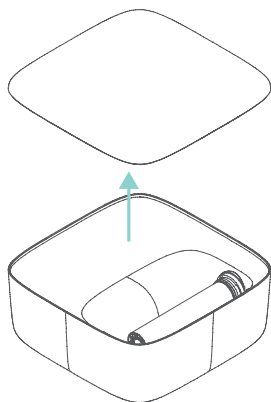

5

Remove pre- and post-filter by unscrewing them counter-clockwise and pull down.

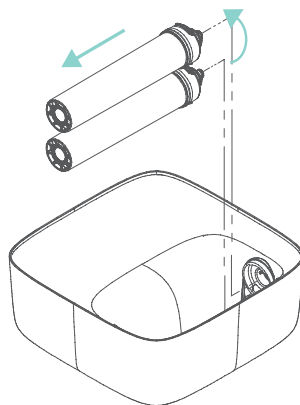

6

Remove the inside cover by pinching gently on the inside and outside of the cover and remove it as shown on the illustration.

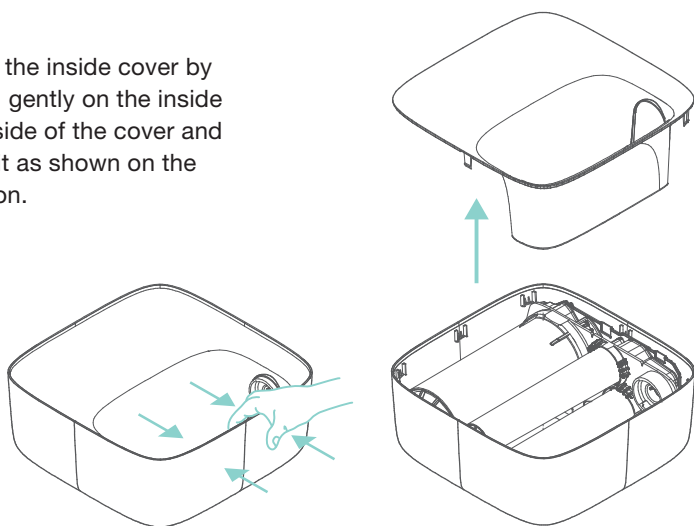

7

Remove the two DWRO™ cartridges by unscrewing them counter-clockwise and pull down.

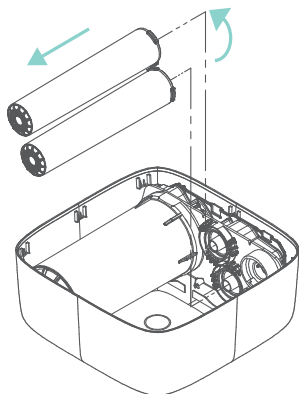

8

Before you insert the new DWRO™ cartridges, wet the O-ring. Insert the new DWRO™ cartridges by pushing them in and tighten by screwing clockwise.

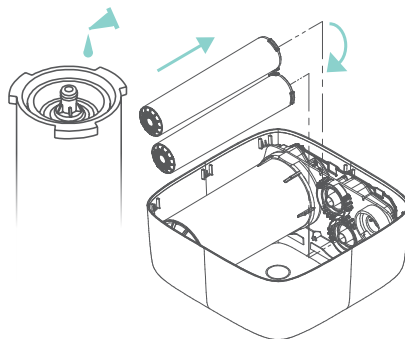

9

Put the internal cover back on.

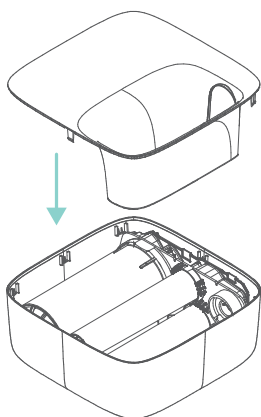

10

Before you insert the new pre- and post-filters, wet the O-ring.

First, insert the post-filter followed by the pre-filter by pushing them in and tighten by screwing clockwise.

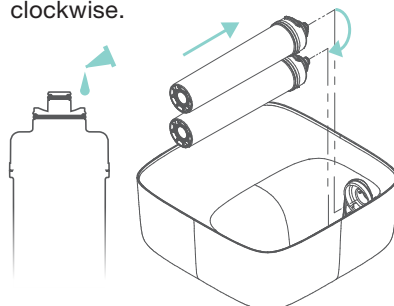

11

Put the lid back on.

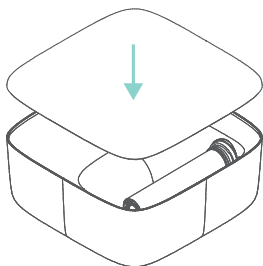
**12**

Turn on the cold water valve.

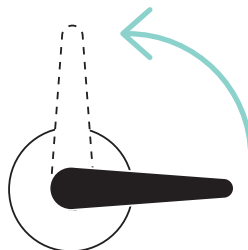
**13**

After replacing the cartridges the system must be flushed before consuming the water. This is done by leaving the faucet open for 15 minutes. The water flow will be slow since the tank is empty. When you close your faucet after 15 minutes the tank will start to fill.

If you experience noises from your ZERO it can be caused by air in the machine. Please follow the steps in the USE section on page 18.

SYSTEM SPECIFICATIONS

ZERO – powered by Aquaporin Inside® is a water purifier dedicated to make safe and great tasting drinking water.

Technical characteristics

Tank	3 L build-in
Pump	No
Power supply	No
Pump noise level	-

Operating specifications

Flow rate	3 L/min
Inlet temperature (min./max.)	5-35 °C
Inlet TDS (max.)	1500 ppm
Inlet pressure (min./max.)	2 / 6 bar
Inlet Chlorine level (max)	0.2 ppm

Treatment steps

Pre-treatment	1 × 0.5 µm Carbon Block
Aquaporin Inside® DWRO membrane	2 × 200 GPD
Post-treatment	1 × 0.5 µm Carbon Block

ZERO

POWERED BY

AQUAPORIN INSIDE®

Aquaporin A/S
Nymøllevej 78
2800 Kongens Lyngby
Denmark

VAT No.: DK28315694
Tel: +45 82 30 30 82
sales@aquaporin.com

aquaporin.com/zero